

CLOSE ALL PIPE ENDS

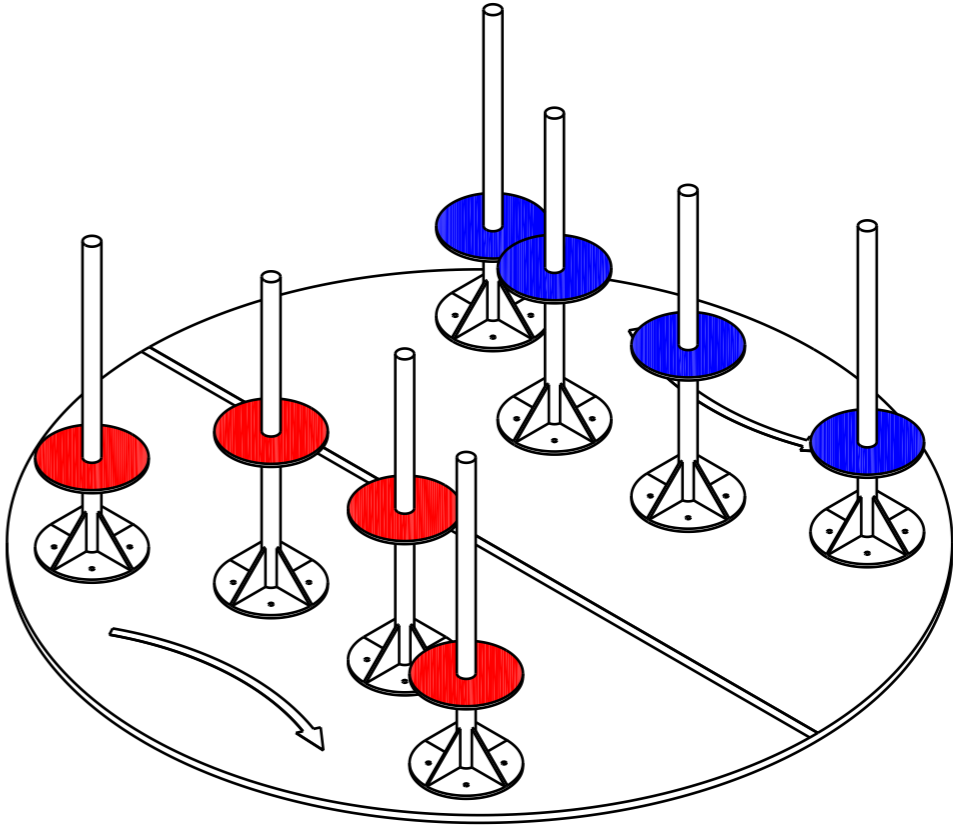

ISOMETRIC VIEW

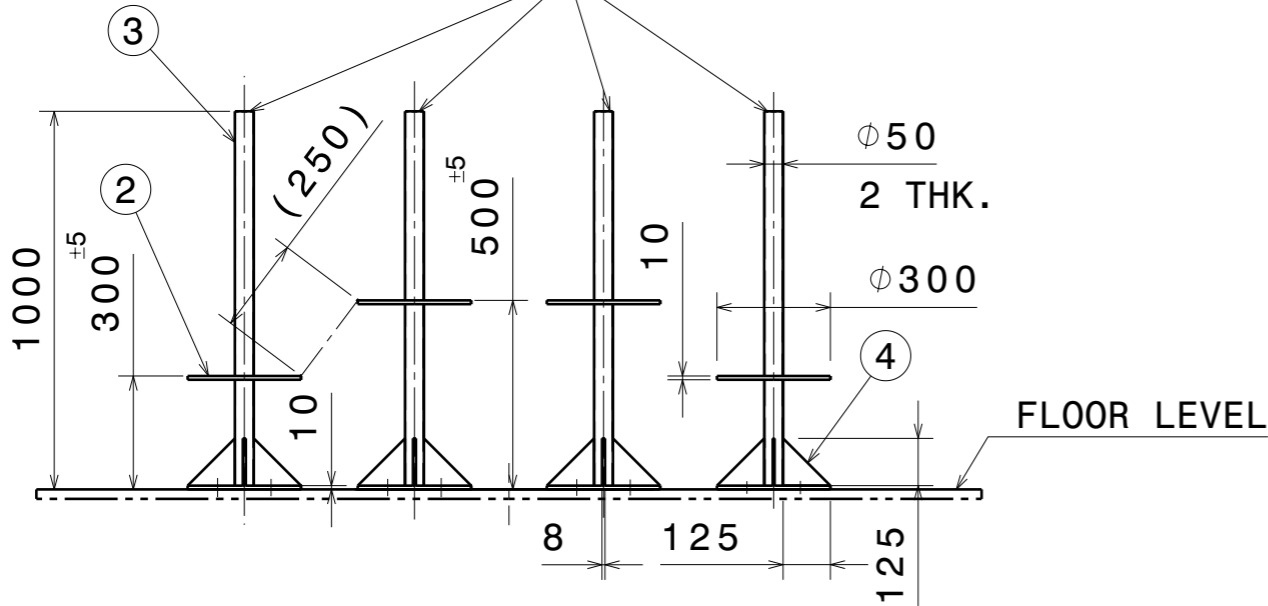
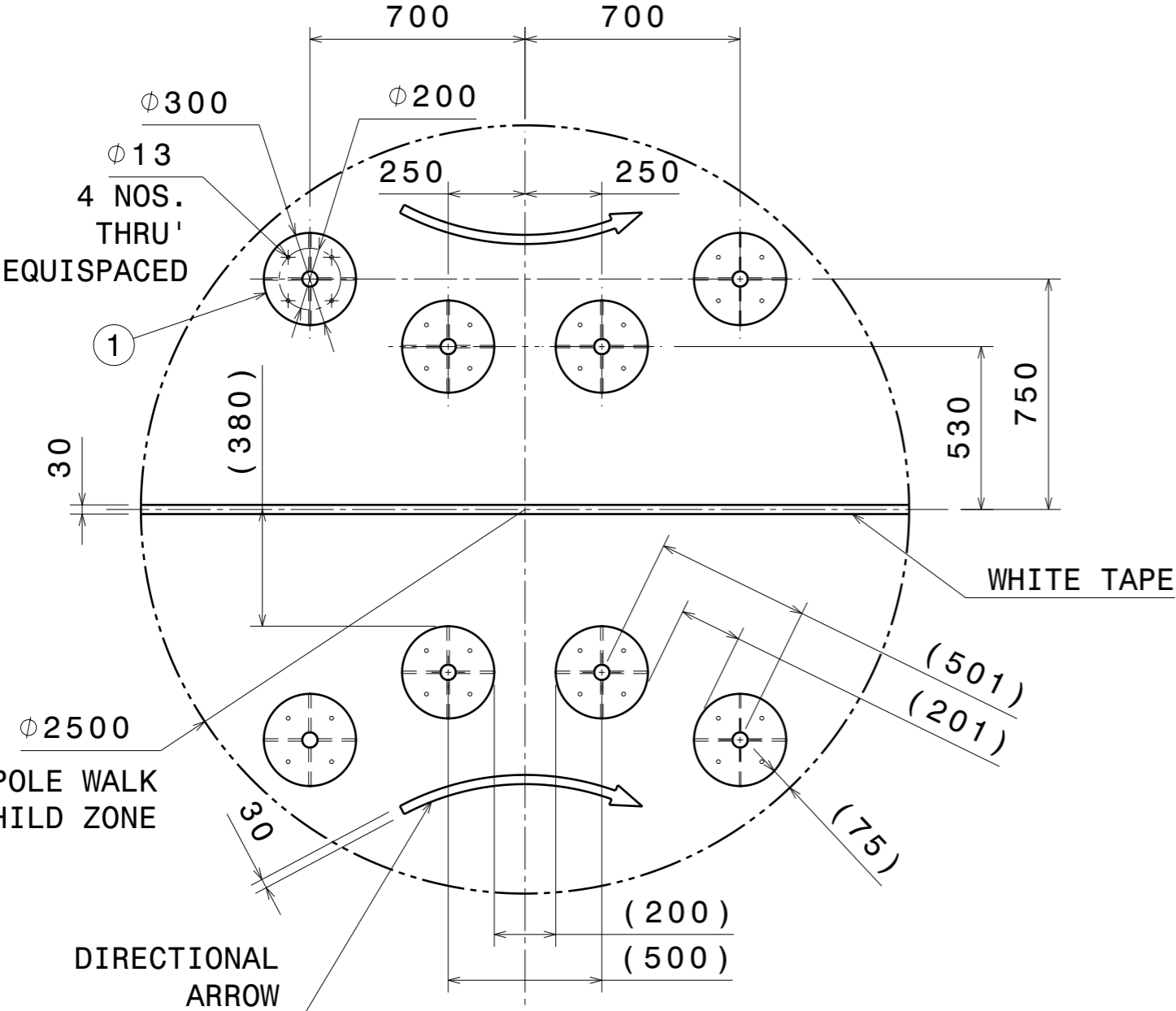

SR. NO.	ITEM DESCRIPTION	MATERIAL	QUANTITY	REMARK
4	WEB	MS	32	125 x 125 x 8 THK.
3	POLE	MS	8	USING $\phi 50$, 2 THK.
2	WALKING DISC	MS	8	$\phi 300$ x 10 THK.
1	BASE PLATE	MS	8	$\phi 300$ x 10 THK.

- NOTES:
- 1) ALL DIMENSIONS IN mm
 - 2) ALL STRUCTURES TO BE PAINTED IN SILVER COLOR (EXCEPT FOR SPECIFIED SURFACES)
 - 3) ENSURE GOOD QUALITY OF WELDING WITH MIN. THROAT THK. 5 mm

		ABU ROBOCON 2014 PUNE, INDIA		
DRAWN BY CHAITANYA		DATE 01/08/2013		FIG 4 - POLE WALK
CHECKED BY COMMITTEE		DATE 01/08/2013		
DESIGNED BY COMMITTEE		DATE 01/08/2013		SIZE A3
		SCALE 1:20		DRAWING NUMBER 004
		WEIGHT (kg) --		REV A
		SHEET 1/1		